

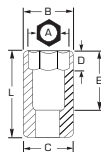

## 1/2" DRIVE DEEP IMPACT SOCKETS

- ▶ Proto® 6 Point Impact Sockets are ideal for use on stubborn or damaged fasteners, and also on fasteners made from soft materials.
- ▶ Socket size stamped on tool for easy identification.
- ▶ Side locking hole.



- ▶ Radius-corner socket design
- ▶ Engages flats for better grip
- ▶ Improves the ability to turn worn or rounded fasteners

1/2" DRIVE IMPACT SOCKETS

INCH	6	12	Nut End Outside Diameter (in) (B)	Drive End Outside Diameter (in) (C)	Nut Depth (in) (D)	Bolt Clearance Depth (in) (E)	Overall Length (in) (L)	Weight (lbs)
3/8	J7312H	J7312	19/32	15/16	15/16	2-5/8	3-1/4	0.42
7/16	J7314H	J7314	23/32	15/16	11/32	1-5/8	3-1/4	0.44
1/2	J7316H	J7316	1-25/32	15/16	7/16	1-5/8	3-1/4	0.43
9/16	J7318H	J7318	7/8	15/16	1/2	1-5/8	3-1/4	0.41
5/8	J7320H	J7320	1	1	9/16	1-5/8	3-1/4	0.44
11/16	J7322H	J7322	1-1/32	1-1/32	5/8	2-5/8	3-1/4	0.47
3/4	J7324H	J7324	1-7/64	1-1/8	1-5/32	2-5/8	3-1/4	0.53
13/16	J7326H	J7326	1-3/16	1-3/16	1-5/32	2-5/8	3-1/4	0.62
7/8	J7328H	J7328	1-19/64	1-9/32	1-13/32	2-7/8	3-1/2	0.78
15/16	J7330H	J7330	1-3/8	1-3/8	1-13/32	2-7/8	3-1/2	0.86
1	J7332H	J7332	1-1/2	1-1/2	1-13/32	2-7/8	3-1/2	1.02
1-1/16	J7334H	J7334	1-1/2	1-33/64	1-17/32	2-7/8	3-1/2	1.11
1-1/8	J7336H	J7336	1-5/8	1-5/8	1-13/32	2-7/8	3-1/2	1.20
1-3/16	J7338H	J7338	1-13/16	1-21/32	1-1/64	2-7/8	3-1/2	1.47
1-1/4	J7340H	J7340	1-13/16	1-21/32	1-1/64	2-7/8	3-1/2	1.39
1-5/16	J7342H	J7342	1-7/8	1-21/32	1-1/16	2-7/8	3-1/2	1.41
1-3/8	J7344H	J7344	1-7/8	1-21/32	1-7/64	2-7/8	3-1/2	1.31
1-7/16	J7346H	J7346	2-1/16	1-21/32	1-5/32	2-7/8	3-1/2	1.67
1-1/2	J7348H	J7348	2-1/16	1-21/32	1-13/64	2-7/8	3-1/2	1.50
1-9/16	J7350H	-	2	1-5/8	1-1/4	1-1/4	3-1/2	1.80

ASME B107.110-2012

MM	6	Nut End Outside Diameter (in) (B)	Drive End Outside Diameter (in) (C)	Nut Depth (in) (D)	Bolt Clearance Depth (in) (E)	Overall Length (in) (L)	Weight (lbs)
8	J7308M*	37/64	7/8	5/16	2-19/32	3-1/4	0.37
9	J7309M	19/32	7/8	3/8	2-19/32	3-1/4	0.36
10	J7310M	41/64	15/16	7/16	2-19/32	3-1/4	0.43
11	J7311M	45/64	15/16	7/16	2-19/32	3-1/4	0.43
12	J7312M	47/64	15/16	1/2	2-19/32	3-1/4	0.43
13	J7313M	25/32	15/16	1/2	2-19/32	3-1/4	0.42
14	J7314M	55/64	15/16	1/2	2-19/32	3-1/4	0.40
15	J7315M	15/16	1	37/64	2-19/32	3-1/4	0.40
16	J7316M	1	1-1/32	19/32	2-19/32	3-1/4	0.46
17	J7317M	1-1/32	1-1/16	5/8	2-19/32	3-1/4	0.45
18	J7318M	1-1/16	1-1/16	43/64	2-19/32	3-1/4	0.49
19	J7319M	1-7/64	1-7/64	1-5/32	2-19/32	3-1/4	0.52
20	J7320M	1-5/32	1-5/32	1-5/32	2-19/32	3-1/4	0.55
21	J7321M	1-13/64	1-13/64	1-13/32	2-19/32	3-1/4	0.66
22	J7322M	1-9/32	1-9/32	1-13/32	2-27/32	3-1/2	0.75
23	J7323M	1-19/64	1-19/64	1-13/32	2-27/32	3-1/2	0.75
24	J7324M	1-23/64	1-23/64	1-13/32	2-27/32	3-1/2	0.81
25	J7325M	1-7/16	1-7/16	1-13/32	2-27/32	3-1/2	0.92
26	J7326M	1-1/2	1-1/2	1-13/32	2-27/32	3-1/2	1.03
27	J7327M	1-9/16	1-9/16	1-13/32	2-27/32	3-1/2	1.14
28	J7328M*	1-5/8	1-5/8	1-13/32	2-27/32	3-1/2	1.20
29	J7329M	1-5/8	1-5/8	1-33/64	2-27/32	3-1/2	1.16
30	J7330M	1-11/16	1-11/16	1-13/32	2-27/32	3-1/2	1.53
32	J7332M	1-25/32	1-25/32	1-13/64	2-27/32	3-1/2	1.32
33	J7333M*	1-55/64	1-55/64	1-25/64	2-27/32	3-1/2	1.48
34	J7334M	1-15/16	1-15/16	1-25/64	2-27/32	3-1/2	1.50
35	J7335M	2-1/16	2-1/16	1-25/64	2-27/32	3-1/2	1.61
36	J7336M	2-1/16	2-1/16	1-25/64	2-27/32	3-1/2	1.63

\*This size not covered under ASME Standards

ASME B107.110-2012

4 4 POINT
6 6 POINT
8 8 POINT
12 12 POINT
SPL SPLINE
TORX TORX®
HEX HEX
BLACK OXIDE